

5250 Satellite Drive

Mississauga, ON

Satellite & Matheson



Unit 7

Total Area	2,051 sq. ft.
Office Area	510 sq. ft.
Clear Height	18 ft.
Shipping	1 Drive-in
Zoning	E-1
Lease Rate	\$10.85 per sq. ft. SEMI-GROSS
Possession	Immediate

Unit 8

Total Area	2,051 sq. ft.
Office Area	510 sq. ft.
Clear Height	18 ft.
Shipping	1 Drive-in
Zoning	E-1
Lease Rate	\$10.85 per sq. ft. SEMI-GROSS
Possession	Immediate

For more information,
please contact:

Hugh Knowles*

Senior Vice President

hknowles@indusite.com

Gary Welch*

Senior Vice President

gwelch@indusite.com

*Sales Representative; **Broker



ONCOR INTERNATIONAL

1015 Matheson Boulevard East, Suite 11 | Mississauga, ON L4W 3A4

T: 905.624-3500 F: 905.624.2636 | www.indusite.com

ALL INFORMATION FURNISHED REGARDING PROPERTY FOR SALE OR LEASE IS FROM SOURCES DEEMED RELIABLE BUT NO WARRANTY OR REPRESENTATION IS MADE AS TO THE ACCURACY THEREOF AND THE SAME SUBMITTED SUBJECT TO ERRORS, OMISSIONS, CHANGE OF PRICE, RENTAL, OR OTHER CONDITIONS, PRIOR SALE OR LEASE, OR WITHDRAWAL WITHOUT NOTICE

5250 Satellite Drive

Mississauga, ON

Satellite & Matheson

Quality Features

- Genuine Quality Construction
- All First Quality Concrete Precast
- Showroom/Office Space Built to Suit
- Architecturally Designed Landscaping
- Public Transit Accessibility
- Room For Expansion
- Generous Parking
- Air Conditioned Offices
- Fully Sprinklered

Advantages

- Energy Efficient
- Roof Insulation
- Insulated Garage Doors
- Thermally Broken Window Frames
- 16' Clear Height
- 12' x 12' Drive-in Garage Doors
- Vestibule Entrances
- Covered Exterior Front Entrances
- Well Lighted Interior and Exterior

Floor Plan Layout

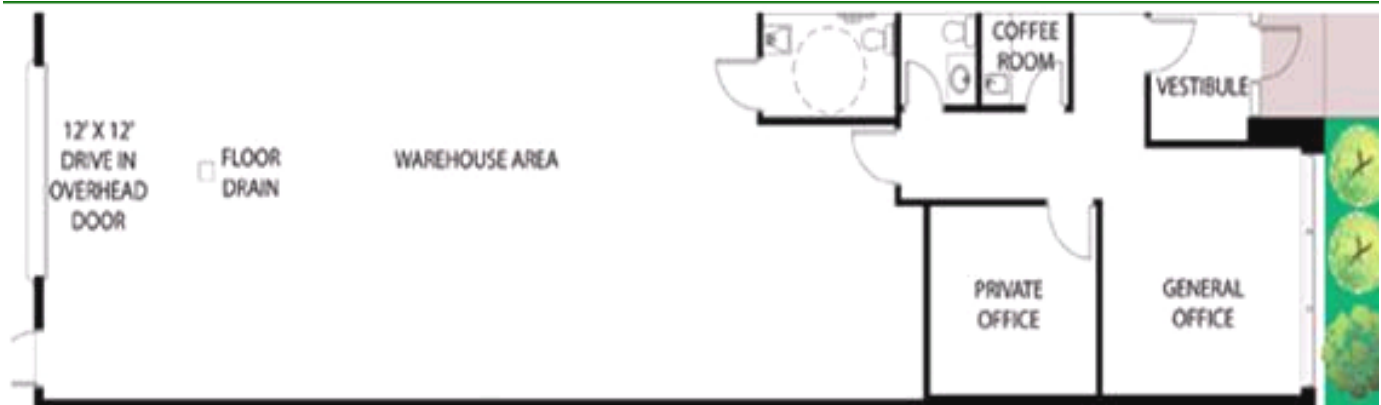

*Sales Representative; **Broker

For more information,
please contact:

Hugh Knowles*

Senior Vice President

hknowles@indusite.com

Gary Welch*

Senior Vice President

gwelch@indusite.com



1015 Matheson Boulevard East, Suite 11 | Mississauga, ON L4W 3A4

T: 905.624-3500 F: 905.624.2636 | www.indusite.com

5250 Satellite Drive

Mississauga, ON

Satellite & Matheson

Site Plan & Aerial

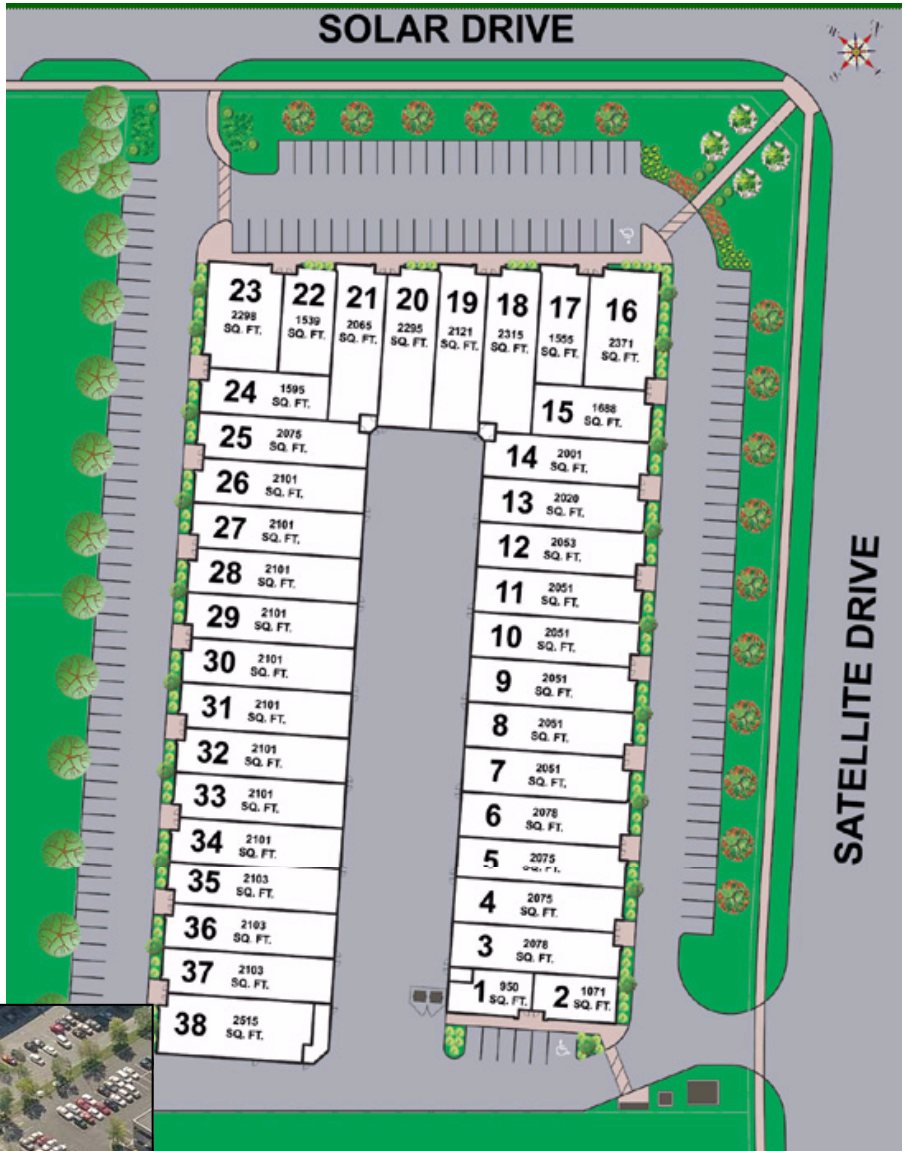

For more information,
please contact:

Hugh Knowles*

Senior Vice President

hknowles@indusite.com

Gary Welch*

Senior Vice President

gwelch@indusite.com



1015 Matheson Boulevard East, Suite 11 | Mississauga, ON L4W 3A4

T: 905.624-3500 F: 905.624.2636 | www.indusite.com