

1515 Matheson Blvd. E., #B11

Mississauga, ON

FOR LEASE

Dixie Road & Matheson Boulevard



Total Area	3,971 sq. ft.
Office Area	800 sq. ft.
Industrial Area	3,171 sq. ft.
Clear Height	14'6"
Shipping	1 Truck Level
Zoning	M1C3-1
Lease Rate	\$6.95 per sq. ft. net

TMI	\$2.96 (2009)
Possession	Immediate
Remarks	<ul style="list-style-type: none">- Excellent exposure onto Matheson Boulevard- Located at Dixie Road & Highway 401 (less than a minute to Hwy 401 ramp)- Suitable for quasi retail/wholesale business- Very clean space- Low TMI- Pylon sign available on Dixie

\$6.95 Per Sq. Ft. Net!

**Sales Representative; **Broker*

For more information, please contact:

John Gilbert**
Vice President
jjgilbert@indusite.com

Dave Robertson*
Vice President
[drobertson@indusite.com](mailto:d Robertson@indusite.com)



ONCOR INTERNATIONAL

1015 Matheson Boulevard East, Suite 11 | Mississauga, ON L4W 3A4 | T: 905.624-3500 F: 905.624.2636 | www.indusite.com

1515 Matheson Blvd. E., #B11

Mississauga, ON

FOR LEASE

Dixie Road & Matheson Boulevard

Building Layout

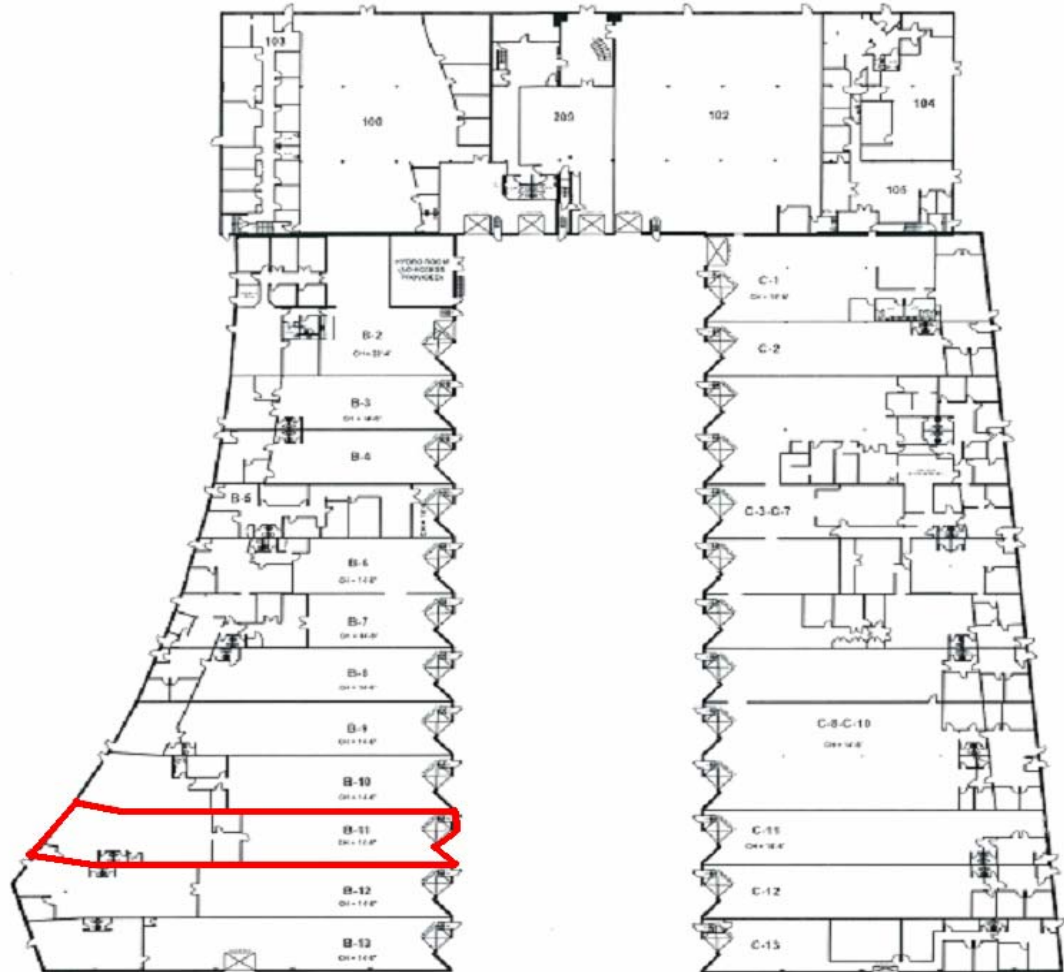

*Sales Representative; **Broker

For more information,
please contact:

John Gilbert**
Vice President
jjgilbert@indusite.com

Dave Robertson*
Vice President
[drobertson@indusite.com](mailto:d Robertson@indusite.com)



ONCOR INTERNATIONAL

1015 Matheson Boulevard East, Suite 11 | Mississauga, ON L4W 3A4 | T: 905.624-3500 F: 905.624.2636 | www.indusite.com