

# 500-530 Keele Street

Toronto, ON

# FOR LEASE

## Keele Centre



	500 Keele Street	530 Keele Street
Unit No.	Unit 103	Units 404-405
Total Area	8,996 sq. ft.	16,488 sq. ft.
Office Area	1,335 sq. ft.	2,700 sq. ft.
Industrial Area	7,661 sq. ft.	13,788 sq. ft.
Clear Height	20'	16'
Shipping	2 Truck Level	4 Truck Level
Lease Rate	\$3.95 per sq. ft. net	\$3.25 per sq. ft. net
Possession	Immediate	30 Days

### Remarks

- Known as "Keele Centre"
- Ideal space in city "core" area
- I-3 zoning
- Power for all units is 600V, 100A
- TMI is \$3.33 (500 Keele); \$3.00 (530 Keele)

For more information please contact

**Jeff Starkey**  
Partner, Broker of Record  
[jstarkey@indusite.com](mailto:jstarkey@indusite.com)

**Ken Donnelly**  
Partner, Broker  
[kdonnelly@indusite.com](mailto:kdonnelly@indusite.com)

**Larry D'Orsay**  
Executive Vice President  
[ldorsay@indusite.com](mailto:ldorsay@indusite.com)

**Matt D'Orsay**  
Senior Vice President  
[mdorsay@indusite.com](mailto:mdorsay@indusite.com)



ONCOR INTERNATIONAL

1015 Matheson Boulevard East, Suite 11 | Mississauga, ON L4W 3A4 | T: 905.624-3500 F: 905.624.2636 | [www.indusite.com](http://www.indusite.com)

# 500-530 Keele Street

Toronto, ON

**FOR LEASE**

Keele Centre

## Aerial & Site Plan

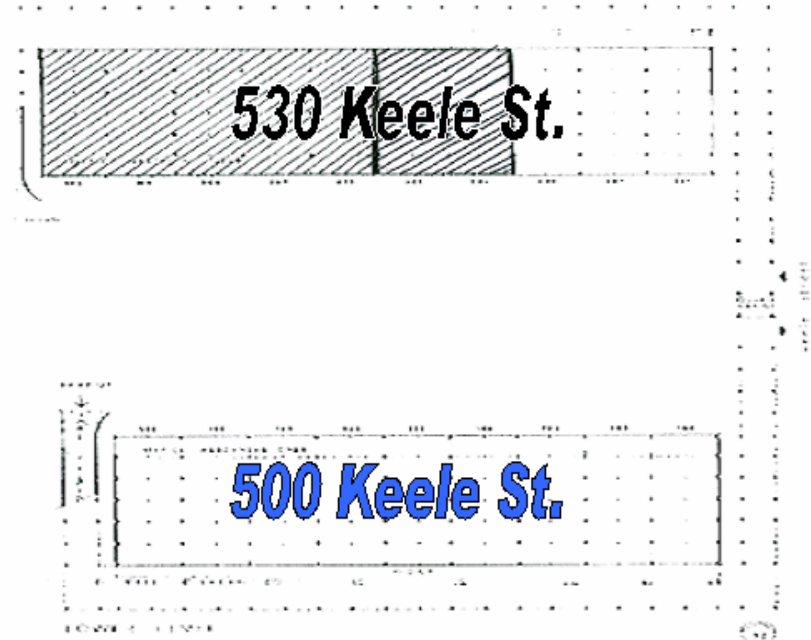

For more information please contact

**Jeff Starkey**  
Partner, Broker of Record  
[jstarkey@indusite.com](mailto:jstarkey@indusite.com)

**Ken Donnelly**  
Partner, Broker  
[kdonnelly@indusite.com](mailto:kdonnelly@indusite.com)

**Larry D'Orsay**  
Executive Vice President  
[ldorsay@indusite.com](mailto:ldorsay@indusite.com)

**Matt D'Orsay**  
Senior Vice President  
[mdorsay@indusite.com](mailto:mdorsay@indusite.com)

1015 Matheson Boulevard East, Suite 11 | Mississauga, ON L4W 3A4 | T: 905.624-3500 F: 905.624.2636 | [www.indusite.com](http://www.indusite.com)