

2550 Goldenridge Road, Units 42-44

Mississauga, ON

FOR LEASE

Dundas Street & Wharton Way



Total Area 10,585 sq. ft.
Retail Area 2,100 sq. ft.
Industrial Area 8,485 sq. ft.
Clear Height 14 ft.
Power 600V, 100A
Shipping 2 Truck Level

Zoning E-1
Lease Rate \$4.95 per square foot net
T.M.I. \$3.26 psf (2010)
Possession Immediate
Remarks
 - Excellent shipping
 - Good parking availability
 - Good highway access
 - Rate to escalate

*For further information,
please contact:*

Jeff Starkey
Partner, Broker of Record
jstarkey@indusite.com

Ken Donnelly
Partner, Broker
kdonnelly@indusite.com



1015 Matheson Boulevard East, Suite 11 | Mississauga, ON L4W 3A4 | T: 905.624-3500 F: 905.624.2636 | www.indusite.com

ALL INFORMATION FURNISHED REGARDING PROPERTY FOR SALE OR LEASE IS FROM SOURCES DEEMED RELIABLE BUT NO WARRANTY OR REPRESENTATION IS MADE AS TO THE ACCURACY THEREOF AND THE SAME SUBMITTED SUBJECT TO ERRORS, OMISSIONS, CHANGE OF PRICE, RENTAL, OR OTHER CONDITIONS, PRIOR SALE OR LEASE, OR WITHDRAWAL WITHOUT NOTICE

2550 Goldenridge Road, Units 42-44

Mississauga, ON

FOR LEASE

Dundas Street & Wharton Way

Floor Plan

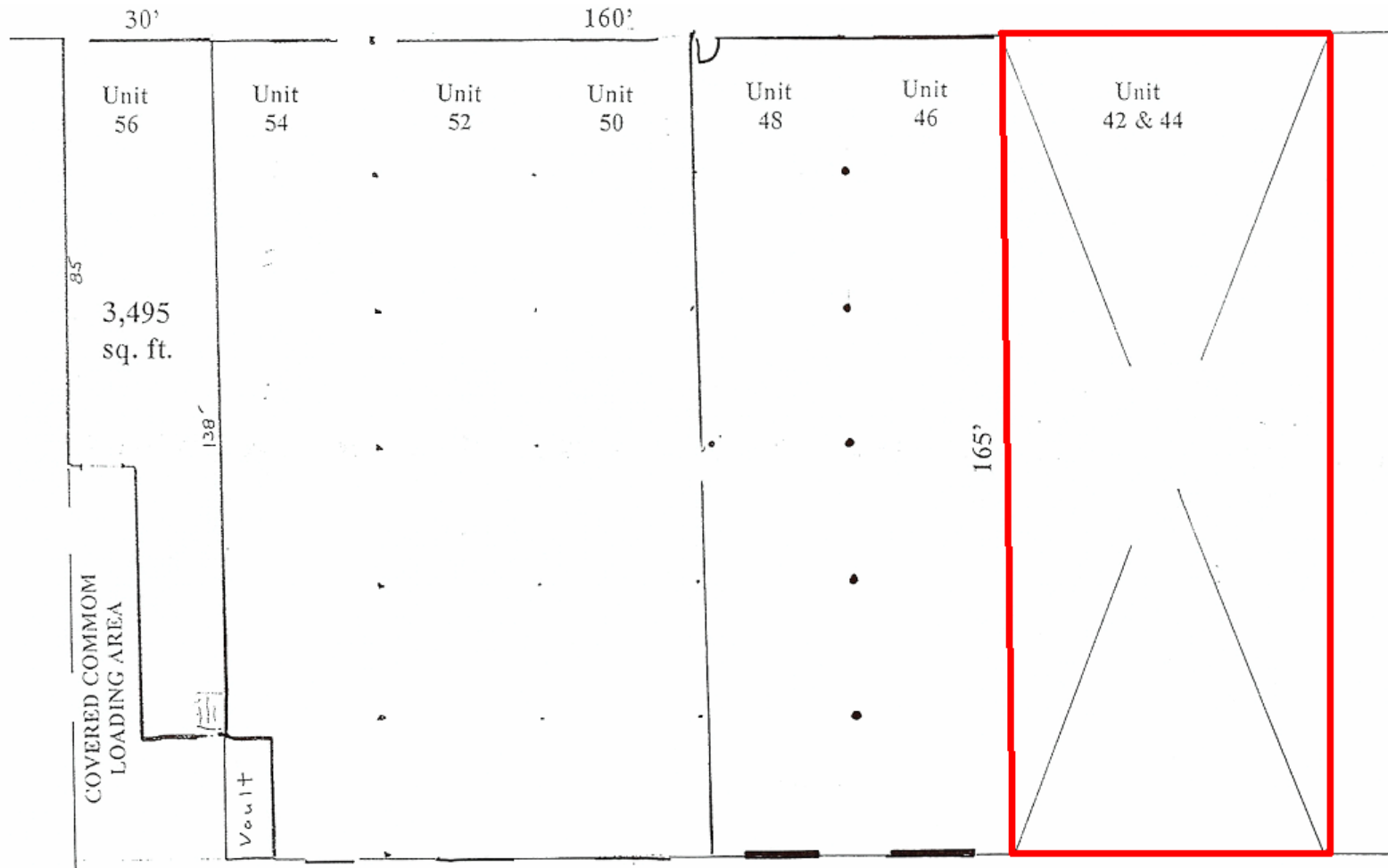

For further information,
please contact:

Jeff Starkey
Partner, Broker of Record
jstarkey@indusite.com

Ken Donnelly
Partner, Broker
kdonnelly@indusite.com

*Sales Representative; **Broker

INDUSITE
REALTY CORPORATION
BROKERAGE

ONCOR INTERNATIONAL

1015 Matheson Boulevard East, Suite 11 | Mississauga, ON L4W 3A4 | T: 905.624-3500 F: 905.624.2636 | www.indusite.com

ALL INFORMATION FURNISHED REGARDING PROPERTY FOR SALE OR LEASE IS FROM SOURCES DEEMED RELIABLE BUT NO WARRANTY OR REPRESENTATION IS MADE AS TO THE ACCURACY THEREOF AND THE SAME SUBMITTED SUBJECT TO ERRORS, OMISSIONS, CHANGE OF PRICE, RENTAL, OR OTHER CONDITIONS, PRIOR SALE OR LEASE, OR WITHDRAWAL WITHOUT NOTICE