

25 Connell Court

Etobicoke, ON

FOR LEASE

QEW & Kipling Avenue



	Size (sq. ft.)	Office (sq. ft.)	Clear Height	Power	Shipping	Lease Rate (psf net)	TMI (psf- 2010)	Possession
Unit 1	26,345	5,100	15'6"	600V, 100A	3 T/L	\$3.25	\$4.05	60 Days
Unit 3	9,360	50	15'6"	600V, 100A	1 T/L	\$3.25	\$4.05	Immediate
Unit 4	11,886	5,000	15'6"	600V, 200A	3 T/L	\$3.95	\$4.05	Immediate
Unit 6	10,188	40	15'6"	600V, 200A	3 T/L	\$1.95	\$4.13	Immediate

For more information, please contact:

*Sales Representative; **Broker



Jeff Starkey*
Partner, Broker of Record
jstarkey@indusite.com

Ken Donnelly*
Partner, Broker
kdonnelly@indusite.com

Larry D'Orsay**
Executive Vice President
ldorsay@indusite.com

Matt D'Orsay*
Senior Vice President
mdorsay@indusite.com

ONCOR INTERNATIONAL

1015 Matheson Boulevard East, Suite 11 | Mississauga, ON L4W 3A4 | T: 905.624-3500 F: 905.624.2636 | www.indusite.com

25 Connell Court

Etobicoke, ON

FOR LEASE

QEW & Kipling Avenue

Site Plan

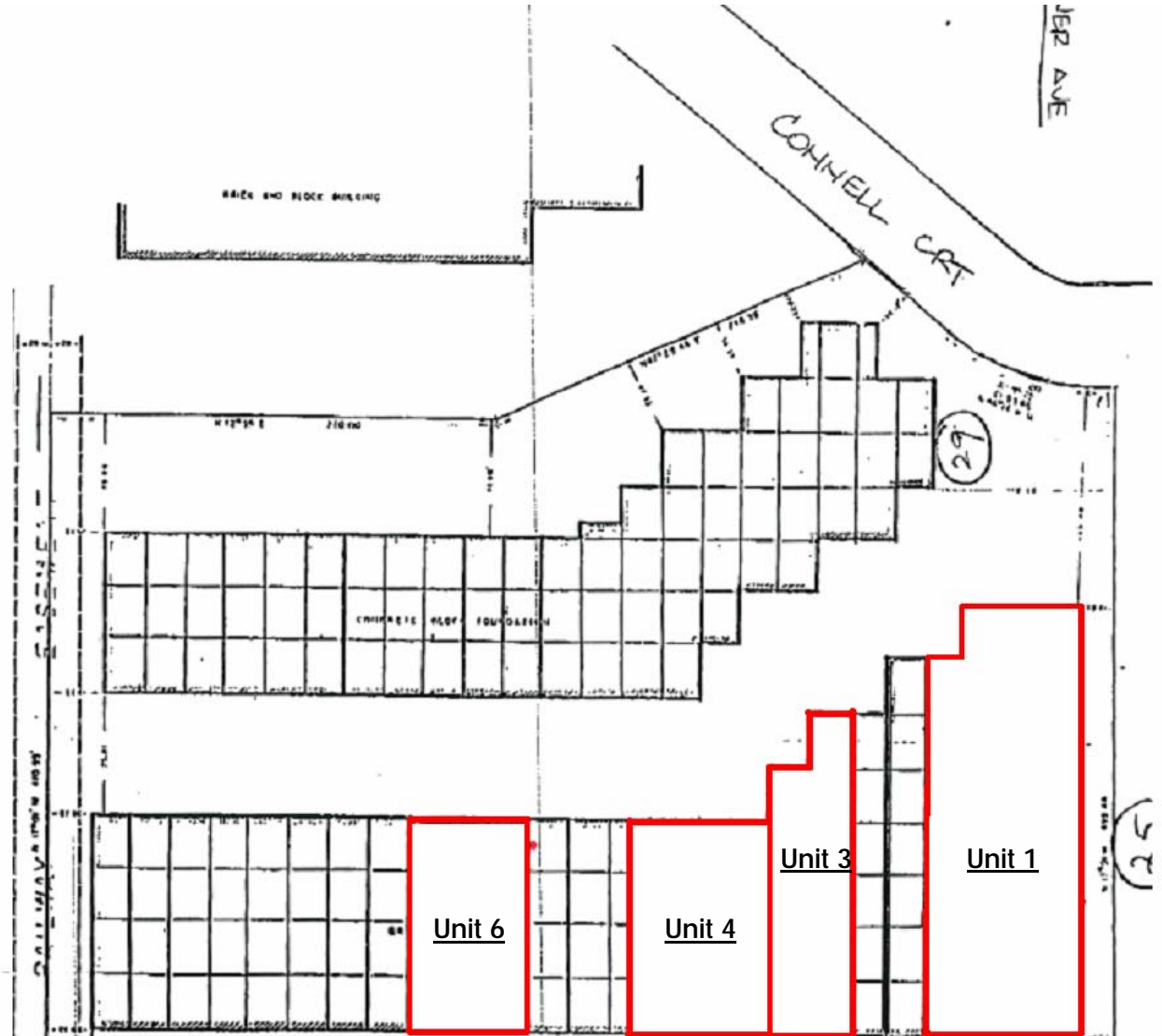

For more information,
please contact:

Jeff Starkey*
Partner, Broker of Record
jstarkey@indusite.com

Ken Donnelly*
Partner, Broker
kdonnelly@indusite.com

Larry D'Orsay**
Executive Vice President
ldorsay@indusite.com

Matt D'Orsay*
Senior Vice President
mdorsay@indusite.com

*Sales Representative; **Broker



ONCOR INTERNATIONAL

1015 Matheson Boulevard East, Suite 11 | Mississauga, ON L4W 3A4 | T: 905.624-3500 F: 905.624.2636 | www.indusite.com

ALL INFORMATION FURNISHED REGARDING PROPERTY FOR SALE OR LEASE IS FROM SOURCES DEEMED RELIABLE BUT NO WARRANTY OR REPRESENTATION IS MADE AS TO THE ACCURACY THEREOF AND THE SAME SUBMITTED SUBJECT TO ERRORS, OMISSIONS, CHANGE OF PRICE, RENTAL, OR OTHER CONDITIONS, PRIOR SALE OR LEASE, OR WITHDRAWAL WITHOUT NOTICE